

Part number

# C7P 10



## Brief description:

surface mounting housings with 2 levers, size "57.27", Pg16, metal version, IP66/ IP67

### Product description

<b>Version</b>	C7 - CV and M7 - MV enclosures, V-Type lever version
<b>Series</b>	Surface mounting housings with two levers
<b>Product type</b>	with 2 stainless steel levers
<b>Family</b>	C7 - CV and M7 - MV enclosures, V-Type lever version
<b>Size</b>	size "57.27"

### Technical data

<b>Material</b>	metal
<b>IP degree of protection</b>	IP66/ IP67 (EN 60529) and IP69K (DIN 40050 - 9) degree of protection.
<b>Cable entry</b>	Pg16

### Further technical details

<b>Weight</b>	262,00 g
---------------	----------

### Approvals / Standards

<b>Quality mark</b>	UL (type:4/4X/12), CE, EAC
<b>Conformity</b>	CQC, CE

### General ordering information

<b>EAN13 code</b>	8015747093545
<b>Tariff number</b>	85369095

### Packaging Information

<b>Packaging length</b>	475,00 mm
<b>Packaging height</b>	170,00 mm
<b>Packaging width</b>	150,00 mm
<b>Packaging weight</b>	5,24 kg
<b>Packaging volume</b>	12,11 dm <sup>3</sup>
<b>Packaging description</b>	Carton box
<b>Packaging quantity</b>	20 Pcs
<b>Packaging EAN code</b>	8015747178198
<b>Sub-packaging weight</b>	1,31 kg
<b>Sub-packaging description</b>	Plastic packaging
<b>Sub-packaging quantity</b>	5 Pcs
<b>Sub-packaging EAN barcode</b>	8015747178204

Part number

# C7P 10



## Catalogue drawings

C7P - C7AP M7P - M7AP

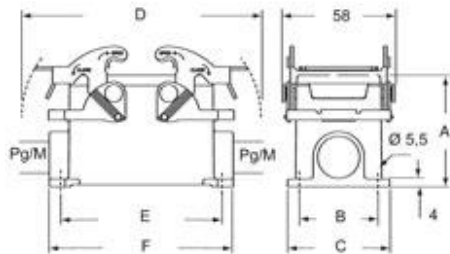

	A	B	C	D	E	F
<b>C7P/M7P 10</b>	57	40	52	122	82	93,5
<b>C7P/M7P 16</b>	63	45	57	142,5	105	117
<b>C7P/M7P 24</b>	63	45	57	169	132	144
<b>C7AP/M7AP 10</b>	73	45	57	122	82	93,5
<b>C7AP/M7AP 16</b>	77	45	57	142,5	105	117
<b>C7AP/M7AP 24</b>	80	45	57	169	132	144

## Notes

### C7P/M7P:

Due to the vertical closing movement, the new lever offers an IP66/IP67 protection (according to EN 60529) when fitted with a complete and coupled connector and used with ILME standard hoods in die cast aluminum with pegs (without adaptor).